



**ARMY PUBLIC SCHOOL AKHNOOR**  
(J & K)-181201  
SCHOOL CODE-23515&  
CBSE AFFILIATION NO - 780012

1862/APS/Quotation

26 Oct 2023

**CALL FOR QUOTATION: UPGRADATION OF HERBAL GARDEN**

1. Quotations are invited for Upgradation of Herbal Garden at Army Public School, Akhnoor. Details of work is as under:-

- (a) Laying of Interlocking paver Blocks.
- (b) Construction of Chain Link Fencing alongwith Angle Iron Post And Iron Gate.
- (c) Hydorponics Set up.

2. The detailed technical specification alongwith proposed sketch of the work are attached at Appx 'A'.

3. The following specifications are also required to be mentioned in the quotation:-

- (a) Total Cost.
- (b) Discount.
- (c) GST, freight and any other charges.
- (d) Time taken to complete the project.
- (e) Experience for similar project completed earlier
- (f) Guarantee/Warranty

4. No advance payment shall be made. The last date of completing the project is 15 Jan 2024. If the work does not completed in the stipulated date and time, penalty of two percent of total cost will be charged per week from you, subject to maximum of 10 percent.

5. You are requested to send your quotation by 08 Nov 2023 duly addressed in sealed envelopes. Quotation will be dropped into the Box kept near main office gate of HQ 255 (I) Armd Bde, C/o 56 APO upto 08 Nov 2023 (1500 hours). In case of quotations send by post, no quotation beyond the stipulated time frame shall be accepted. Bids not in conformity with the quoted specifications will be rejected.

**Note:-** Area measured is tentative. Interested bidders may visit the site of work before quoting the cost of work.

  
(Geeta Devi)  
Principal

## Technical Details

Appx 'A'

### Providing and Laying of Interlocking Paver Block at Army Public School, Akhnoor

S/No.	Brief Specification	Remark
1.	<b><u>Scope of Work:-</u></b> Providing and Laying of Interlocking Paver Block at various location as following steps.	
2.	<b><u>Civil Work-</u></b>  (A) Earth work in surface excavation not exceeding 30 cm in depth but exceeding 1.5 m in width as well as 10 sqm on plan including getting out and disposal of excavated earth upto 50 m and lift upto 1.5 m, as directed by APS Engineer-in- Charge ( <b>Thickness approx 300 mm</b> )  (B) Cement concrete 1:2:4 (1 cement : 2 coarse sand : 4 graded stone aggregate 40 mm nominal size) in pavements, laid to required slope and camber in panels as required including consolidation finishing and tamping complete. ( <b>Thickness approx 100 mm</b> )  (C) Providing and laying 60mm thick factory made cement concrete interlocking paver block of M -30 grade made by block making machine with strong vibratory compaction, of approved size, design & shape, laid in required colour and pattern over and including 50mm thick compacted bed of coarse sand, filling the joints with line sand etc. all complete as per the direction of APS Engineer-in-charge.  (D) Providing and laying cement concrete in kerbs, steps and the like at or near ground level excluding the cost of centering, shuttering and finishing with 1:1½:3 (1 Cement: 1½ coarse sand(zone-III) derived from natural sources : 3 graded stone aggregate 20 mm nominal size derived from natural source to protect the edges of the interlocking paver block . ( <b>Thickness approx 150 mm</b> )  (E ) Disposal of excavated soil / malba / similar unserviceable, or waste materials by mechanical means, including loading, transporting, unloading to approved municipal dumping ground or as approved by APS Engineer-in-charge, beyond 50 m initial lead, for all leads including all lifts involved.  <b><u>Note:-</u></b>	

*Feel*



1. Rates shall be quoted rate including GST, all other taxes and overhead charge if required,
2. Contractors are requested to see work sites before quoting their rates.
3. Contractors are advised to avoid the conditional rebate on their Quoted rates.
4. Cement 43 grade as approved (ACC, Ambuja, Birla, L&T, Ultratech, Sri Cement) by the Ministry of Industry, Government of India for civil works shall be used.

***"The work shall be carried out strictly according to lasted CPWD Specifications and IS code in confirmation to I.E rules."***

60 mm THICK BLOCKS

30 ± 5 mm THICK SAND BED

200 mm THICK BASE LAYER OF WBM/WM/CRUSHED ROCK/ SOIL-CEMENT

COMPACTED EARTH

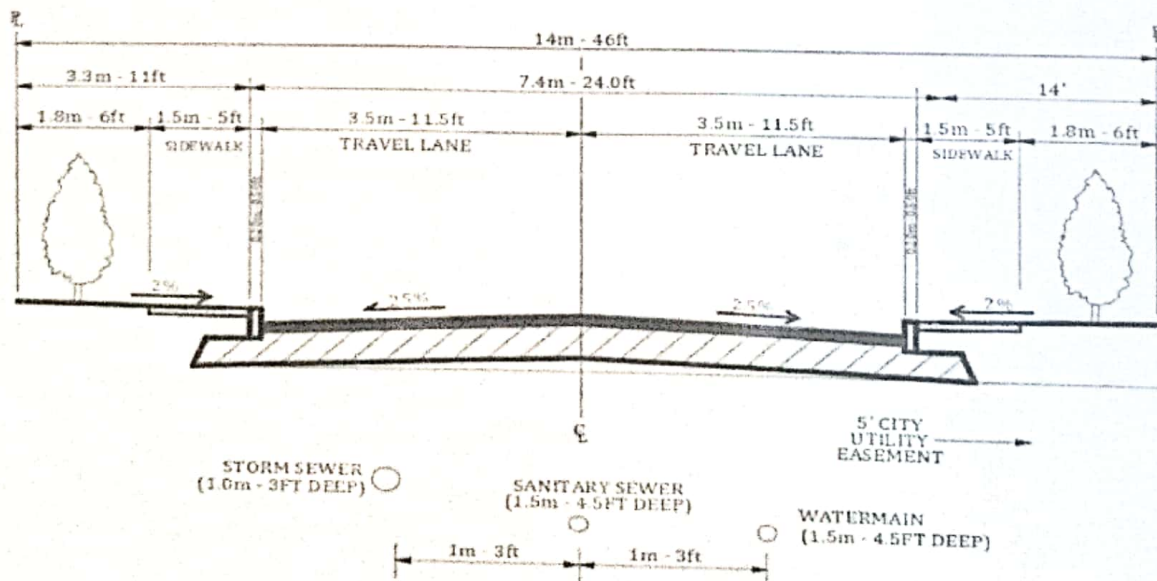

*9/2/22*

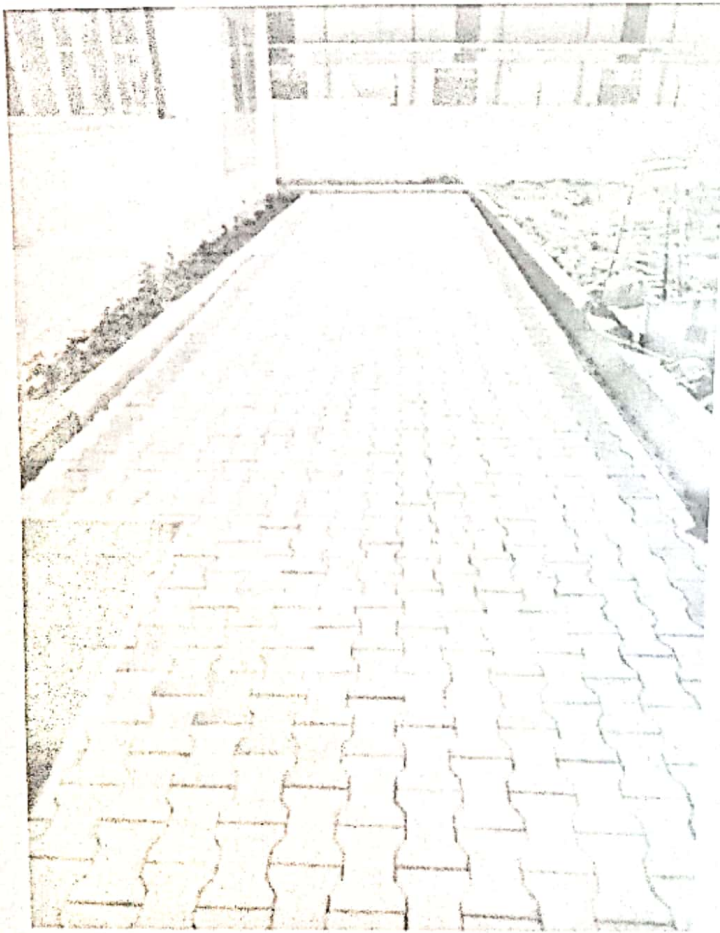
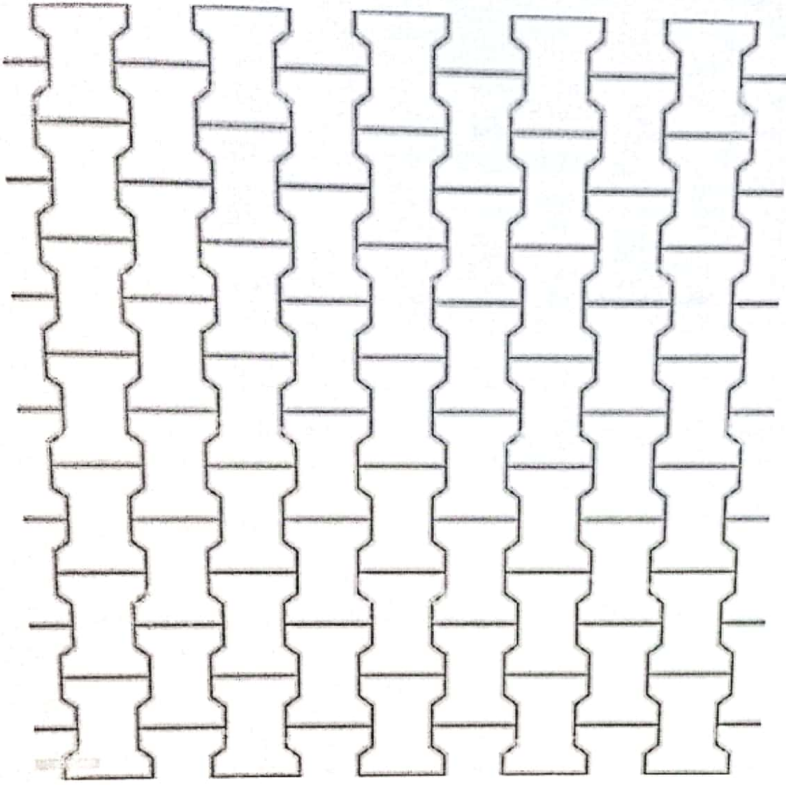

Geel. 1



Technical DetailsCONSTRUCTION OF CHAIN LINK FENCING ALONG WITH ANGLE IRON POST AND IRON GATE  
FOR HERBAL GARDEN AT APS AKHNOOR

S/No.	Brief Specification	Remark
1.	<p><b><u>Scope of Work:-</u></b> Construction/ development of chain link fencing (Total Length of fencing approx 148.feet. &amp; Height above ground 5 feet and below ground 1.5 feet. (approx.)</p> <p><b><u>TECHNICAL SPECIFICATION:-</u></b></p> <p><b><u>1. IRON POST:-</u></b> M.S Hollow Section Tube post (weight not less then 4 kg per mtr,) Size of Post 50x50x3 mm, Length of Post 2.1 mtr. To be placed at 2.10 mtr distance embedded in cement concrete blocks, every 15th post, and end post or corner post shall be strutted on both sides cross support Angle iron 45x45X5 mm, Length of cross 3.0 mtr.</p> <p><b><u>2. ANGLE IRON FRAME:-</u></b> Angle Iron frame make Angle Iron 40x40x5 mm, and drilling holes upto 10 mm dia. Every 300 mm distance, Size of frame (6'-6"x 5'-0") as per drawing.</p> <p><b><u>3. CHAIN LINK FENCING</u></b> Providing and fixing G.I. chain link fabric fencing, mesh size 50x50 mm, Made of G.I. wire of dia 4 mm including strengthening with 6 mm dia nuts, and washers as required to be fixed along with 40x5 mm Iron flat complete.</p> <p><b><u>4. CEMENT CONCRETE FOOTING</u></b> Fixing to M S Post and embedding in cement concrete block 30x30x45cm 1:2:4 mix (1 cement : 2 coarse sand : 4 graded stone aggregate 20mm nominal size)</p> <p><b><u>5. IRON GATE (2 NOS)</u></b> Fabrication and erection of Iron Gate/ Tubular section 60x40 or 50x40 or 70x40 heavy duty, size 8 x 6 feet wt. as per drawing.</p> <p><b><u>6. PAINTING WITH ENAMEL PAINT</u></b> Painting with synthetic enamel paint of approved brand and manufacture with primer coat and two coat paint both side of Chain link fencing along with post, gate and others Iron frame structure etc.</p>	

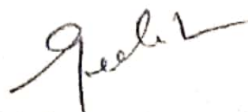

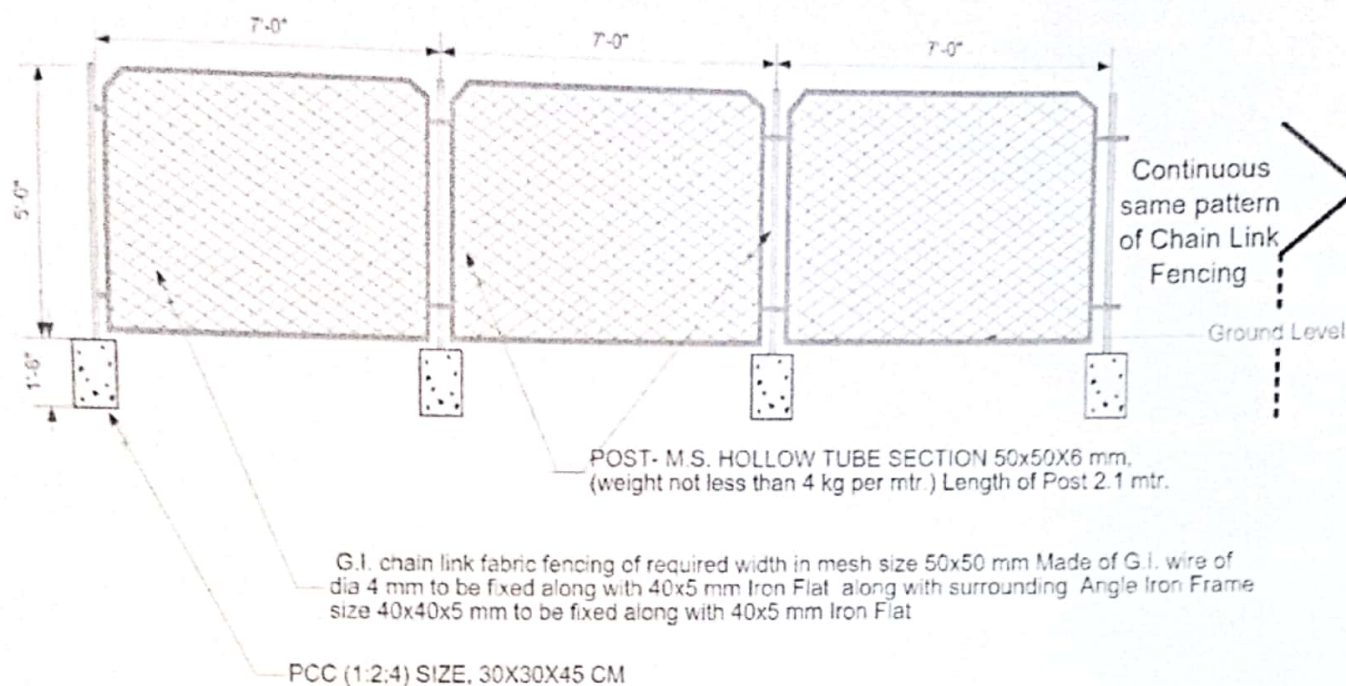

### Design of Gate for Herbal Garden

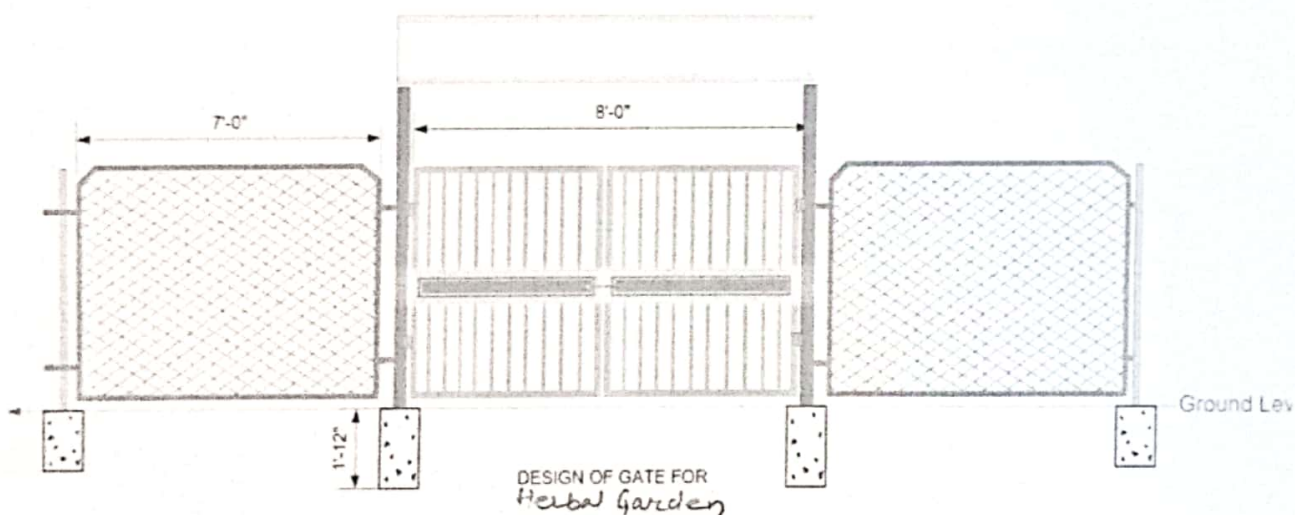

*Feel*

# LAYOUT MAP

Appx 'A' (contd...)

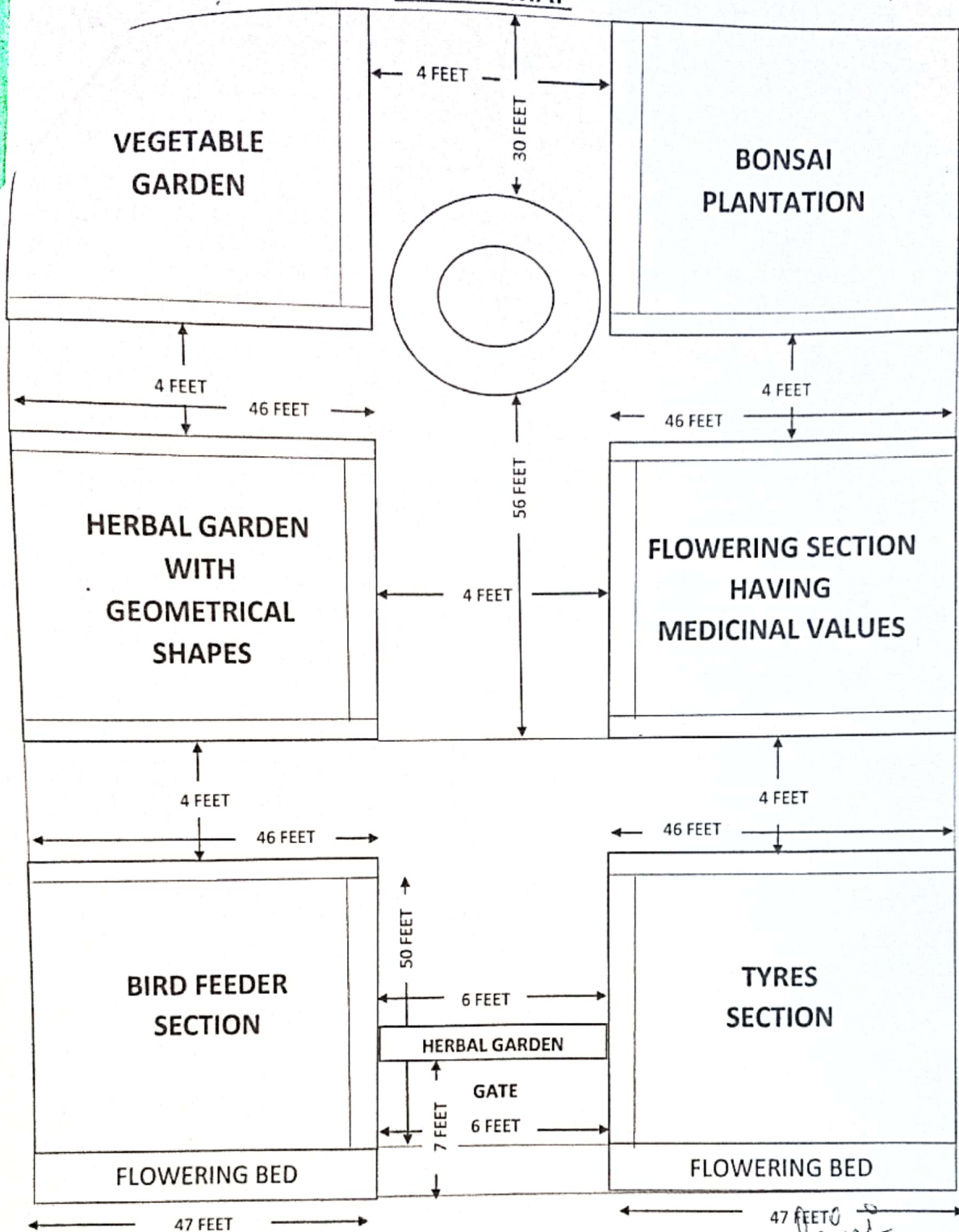

ROAD 100 FEET

Presiding Offr.: Mrs. Rajani Banaut, TGT

Member No. 1. Mrs. Shashi Sharma, TGT

2. Mrs. Amita Sharma, PRT

(Geeta Devi)  
Principal



APPROX AREA FOR UGRADATION OF HERBAL GARDEN AT APS AKHNOOR

- (a) Pathway - 1404 Sq ft
- (b) Fencing - (i) Front -  $47\text{ft} \times 3\text{ft (Height)} = 141\text{ Sqft} \times 2 = 282\text{ SqFt}$   
(ii) Vertical Garden -  $30\text{ Ft} \times 5\text{ ft (Height)} = 150\text{ Sqft}$   
Total = 432 Sq ft
- (c) Hydroponics - 5 Sets, 10 ft x 5 ft each.
- (d) Gate -  $7 \times 7\text{ Ft} = 49\text{ Sq ft}$

*guel*